

* required information

Section 1 of 19

You can save the form at any time and resume it later. You do not need to be logged in when you resume.

System reference This is the unique reference for this application generated by the system.

Your reference You can put what you want here to help you track applications if you make lots of them. It is passed to the authority.

Are you an agent acting on behalf of the applicant?

☐ Yes ☒ No

Put "no" if you are applying on your own behalf or on behalf of a business you own or work for.

Applicant Details

* First name

* Family name

* E-mail

Main telephone number Include country code.

Other telephone number

☐ Indicate here if you would prefer not to be contacted by telephone

Are you:

☒ Applying as a business or organisation, including as a sole trader

☐ Applying as an individual

A sole trader is a business owned by one person without any special legal structure. Applying as an individual means you are applying so you can be employed, or for some other personal reason, such as following a hobby.

Applicant Business

* Is your business registered in the UK with Companies House? ☒ Yes ☐ No

* Registration number

* Business name If your business is registered, use its registered name.

* VAT number Put "none" if you are not registered for VAT.

* Legal status

Continued from previous page...

* Your position in the business

Home country

The country where the headquarters of your business is located.

Registered Address

Address registered with Companies House.

* Building number or name

* Street

District

* City or town

County or administrative area

* Postcode

* Country

Section 2 of 19

PREMISES DETAILS

I/we, as named in section 1, apply for a premises licence under section 17 of the Licensing Act 2003 for the premises described in section 2 below (the premises) and I/we are making this application to you as the relevant licensing authority in accordance with section 12 of the Licensing Act 2003.

Premises Address

Are you able to provide a postal address, OS map reference or description of the premises?

☒ Address ☐ OS map reference ☐ Description

Postal Address Of Premises

Building number or name

Street

District

City or town

County or administrative area

Postcode

Country

Further Details

Telephone number

Non-domestic rateable value of premises (£)

Section 3 of 19

APPLICATION DETAILS

In what capacity are you applying for the premises licence?

- ☐ An individual or individuals
- ☒ A limited company
- ☐ A partnership
- ☐ An unincorporated association
- ☐ A recognised club
- ☐ A charity
- ☐ The proprietor of an educational establishment
- ☐ A health service body
- ☐ A person who is registered under part 2 of the Care Standards Act 2000 (c14) in respect of an independent hospital in Wales
- ☐ A person who is registered under Chapter 2 of Part 1 of the Health and Social Care Act 2008 in respect of the carrying on of a regulated activity (within the meaning of that Part) in an independent hospital in England
- ☐ The chief officer of police of a police force in England and Wales
- ☐ Other (for example a statutory corporation)

Confirm The Following

- ☒ I am carrying on or proposing to carry on a business which involves the use of the premises for licensable activities
- ☐ I am making the application pursuant to a statutory function
- ☐ I am making the application pursuant to a function discharged by virtue of Her Majesty's prerogative

Section 4 of 19

NON INDIVIDUAL APPLICANTS

Provide name and registered address of applicant in full. Where appropriate give any registered number. In the case of a partnership or other joint venture (other than a body corporate), give the name and address of each party concerned.

Non Individual Applicant's Name

Name

Details

Registered number (where applicable)

Description of applicant (for example partnership, company, unincorporated association etc)

Continued from previous page...

Address

Building number or name

Street

District

City or town

County or administrative area

Postcode

Country

Contact Details

E-mail

Telephone number

Other telephone number

Add another applicant

Section 5 of 19

OPERATING SCHEDULE

When do you want the premises licence to start? / /
dd mm yyyy

If you wish the licence to be valid only for a limited period, when do you want it to end / /
dd mm yyyy

Provide a general description of the premises

For example the type of premises, its general situation and layout and any other information which could be relevant to the licensing objectives. Where your application includes off-supplies of alcohol and you intend to provide a place for consumption of these off-supplies you must include a description of where the place will be and its proximity to the premises.

With the PDF form i will send a following map of the restaurant with internal structure of seating area and bar layout.

If 5,000 or more people are expected to attend the premises at any one time, state the number expected to attend

Continued from previous page...

Section 6 of 19

PROVISION OF PLAYS

Will you be providing plays?

☐ Yes

☒ No

Section 7 of 19

PROVISION OF FILMS

Will you be providing films?

☐ Yes

☒ No

Section 8 of 19

PROVISION OF INDOOR SPORTING EVENTS

Will you be providing indoor sporting events?

☐ Yes

☒ No

Section 9 of 19

PROVISION OF BOXING OR WRESTLING ENTERTAINMENTS

Will you be providing boxing or wrestling entertainments?

☐ Yes

☒ No

Section 10 of 19

PROVISION OF LIVE MUSIC

Will you be providing live music?

☐ Yes

☒ No

Section 11 of 19

PROVISION OF RECORDED MUSIC

Will you be providing recorded music?

☒ Yes

☐ No

Standard Days And Timings

MONDAY

Start

End

Start

End

TUESDAY

Start

End

Start

End

WEDNESDAY

Start

End

Start

End

Give timings in 24 hour clock.
(e.g., 16:00) and only give details for the days
of the week when you intend the premises
to be used for the activity.

Continued from previous page...

THURSDAY

Start 11:00

End 00:00

Start

End

FRIDAY

Start 11:00

End 00:00

Start

End

SATURDAY

Start 11:00

End 00:00

Start

End

SUNDAY

Start 12:00

End 23:30

Start

End

Will the playing of recorded music take place indoors or outdoors or both?

☒ Indoors

☐ Outdoors

☐ Both

Where taking place in a building or other structure tick as appropriate. Indoors may include a tent.

State type of activity to be authorised, if not already stated, and give relevant further details, for example (but not exclusively) whether or not music will be amplified or unamplified.

N/A

State any seasonal variations for playing recorded music

For example (but not exclusively) where the activity will occur on additional days during the summer months.

N/A

Non-standard timings. Where the premises will be used for the playing of recorded music at different times from those listed in the column on the left, list below

For example (but not exclusively), where you wish the activity to go on longer on a particular day e.g. Christmas Eve.

Christmas Eve, New years day, New years Eve

Section 12 of 19

PROVISION OF PERFORMANCES OF DANCE

Will you be providing performances of dance?

Continued from previous page...

☐ Yes

☒ No

Section 13 of 19

PROVISION OF ANYTHING OF A SIMILAR DESCRIPTION TO LIVE MUSIC, RECORDED MUSIC OR PERFORMANCES OF DANCE

Will you be providing anything similar to live music, recorded music or performances of dance?

☐ Yes

☒ No

Section 14 of 19

LATE NIGHT REFRESHMENT

Will you be providing late night refreshment?

☒ Yes

☐ No

Standard Days And Timings

MONDAY

Start

End

Start

End

TUESDAY

Start

End

Start

End

WEDNESDAY

Start

End

Start

End

THURSDAY

Start

End

Start

End

FRIDAY

Start

End

Start

End

SATURDAY

Start

End

Start

End

SUNDAY

Start

End

Start

End

Give timings in 24 hour clock.
(e.g., 16:00) and only give details for the days
of the week when you intend the premises
to be used for the activity.

Continued from previous page...

Will the provision of late night refreshment take place indoors or outdoors or both?

☒ Indoors ☐ Outdoors ☐ Both

Where taking place in a building or other structure tick as appropriate. Indoors may include a tent.

State type of activity to be authorised, if not already stated, and give relevant further details, for example (but not exclusively) whether or not music will be amplified or unamplified.

N/A

State any seasonal variations

For example (but not exclusively) where the activity will occur on additional days during the summer months.

N/A

Non-standard timings. Where the premises will be used for the supply of late night refreshments at different times from those listed in the column on the left, list below

For example (but not exclusively), where you wish the activity to go on longer on a particular day e.g. Christmas Eve.

Activities shall go on longer on the following days: Christmas Eve, New Years Day, New Years Eve

Section 15 of 19

SUPPLY OF ALCOHOL

Will you be selling or supplying alcohol?

☒ Yes ☐ No

Standard Days And Timings

MONDAY

Start

End

Start

End

TUESDAY

Start

End

Start

End

Give timings in 24 hour clock.
(e.g., 16:00) and only give details for the days
of the week when you intend the premises
to be used for the activity.

Continued from previous page...

WEDNESDAY

Start 11:00

End 00:00

Start

End

THURSDAY

Start 11:00

End 00:00

Start

End

FRIDAY

Start 11:00

End 00:00

Start

End

SATURDAY

Start 11:00

End 00:00

Start

End

SUNDAY

Start 12:00

End 23:30

Start

End

Will the sale of alcohol be for consumption:

☒ On the premises ☐ Off the premises ☐ Both

If the sale of alcohol is for consumption on the premises select on, if the sale of alcohol is for consumption away from the premises select off. If the sale of alcohol is for consumption on the premises and away from the premises select both.

State any seasonal variations

For example (but not exclusively) where the activity will occur on additional days during the summer months.

N/A

Non-standard timings. Where the premises will be used for the supply of alcohol at different times from those listed in the column on the left, list below

For example (but not exclusively), where you wish the activity to go on longer on a particular day e.g. Christmas Eve.

Yes during the following day ; Christmas eve, New years day, New years eve

State the name and details of the individual whom you wish to specify on the licence as premises supervisor

Continued from previous page...

Name

First name

Family name

Enter the contact's address

Building number or name

Street

District

City or town

County or administrative area

Postcode

Country

Personal Licence number
(if known)

Issuing licensing authority
(if known)

PROPOSED DESIGNATED PREMISES SUPERVISOR CONSENT

How will the consent form of the proposed designated premises supervisor be supplied to the authority?

- ☐ Electronically, by the proposed designated premises supervisor
- ☒ As an attachment to this application

Reference number for consent form (if known)

If the consent form is already submitted, ask the proposed designated premises supervisor for its 'system reference' or 'your reference'.

Section 16 of 19

ADULT ENTERTAINMENT

Highlight any adult entertainment or services, activities, or other entertainment or matters ancillary to the use of the premises that may give rise to concern in respect of children

Give information about anything intended to occur at the premises or ancillary to the use of the premises which may give rise to concern in respect of children, regardless of whether you intend children to have access to the premises, for example (but not exclusively) nudity or semi-nudity, films for restricted age groups etc gambling machines etc.

N/A

Section 17 of 19

HOURS PREMISES ARE OPEN TO THE PUBLIC

Continued from previous page...

Standard Days And Timings

MONDAY

Start

End

Start

End

Give timings in 24 hour clock.
(e.g., 16:00) and only give details for the days
of the week when you intend the premises
to be used for the activity.

TUESDAY

Start

End

Start

End

WEDNESDAY

Start

End

Start

End

THURSDAY

Start

End

Start

End

FRIDAY

Start

End

Start

End

SATURDAY

Start

End

Start

End

SUNDAY

Start

End

Start

End

State any seasonal variations

For example (but not exclusively) where the activity will occur on additional days during the summer months.

N/A

Non standard timings. Where you intend to use the premises to be open to the members and guests at different times from those listed in the column on the left, list below

For example (but not exclusively), where you wish the activity to go on longer on a particular day e.g. Christmas Eve.

Activities we go on longer; Christmas Eve, New years day, New years Eve

Continued from previous page...

Section 18 of 19

LICENSING OBJECTIVES

Describe the steps you intend to take to promote the four licensing objectives:

a) General – all four licensing objectives (b,c,d,e)

List here steps you will take to promote all four licensing objectives together.

b) The prevention of crime and disorder

Alcohol only served ancillary to a table meal

c) Public safety

Signs are always up if there is a wet floor

d) The prevention of public nuisance

Any one that has gone beyond the alcohol limit will be sent away from the premises.

e) The protection of children from harm

We challenge anyone that under the age of 18.

Section 19 of 19

PAYMENT DETAILS

This fee must be paid to the authority. If you complete the application online, you must pay it by debit or credit card.

Premises Licence Fees are determined by the non-domestic rateable value of the premises.

To find out a premises non domestic rateable value go to the Valuation Office Agency site at http://www.voa.gov.uk/business_rates/index.htm

Band A - No RV to £4300 £100.00

Band B - £4301 to £33000 £190.00

Band C - £33001 to £8700 £315.00

Band D - £87001 to £12500 £450.00*

Band E - £125001 and over £635.00*

*If the premises rateable value is in Bands D or E and the premises is primarily used for the consumption of alcohol on the premises then you are required to pay a higher fee

Continued from previous page...

Band D - £87001 to £12500 £900.00

Band E - £125001 and over £1,905.00

There is an exemption from the payment of fees in relation to the provision of regulated entertainment at church halls, chapel halls or premises of a similar nature, village halls, parish or community halls, or other premises of a similar nature. The costs associated with these licences will be met by central Government. If, however, the licence also authorises the use of the premises for the supply of alcohol or the provision of late night refreshment, a fee will be required.

Schools and sixth form colleges are exempt from the fees associated with the authorisation of regulated entertainment where the entertainment is provided by and at the school or college and for the purposes of the school or college.

If you operate a large event you are subject to ADDITIONAL fees based upon the number in attendance at any one time

Capacity 5000-9999 £1,000.00

Capacity 10000 -14999 £2,000.00

Capacity 15000-19999 £4,000.00

Capacity 20000-29999 £8,000.00

Capacity 30000-39000 £16,000.00

Capacity 40000-49999 £24,000.00

Capacity 50000-59999 £32,000.00

Capacity 60000-69999 £40,000.00

Capacity 70000-79999 £48,000.00

Capacity 80000-89999 £56,000.00

Capacity 90000 and over £64,000.00

* Fee amount (£)

190.00

ATTACHMENTS

AUTHORITY POSTAL ADDRESS

Address

Building number or name

Street

District

City or town

County or administrative area

Postcode

Country

United Kingdom

DECLARATION

* I/we understand it is an offence, liable on conviction to a fine up to level 5 on the standard scale, under section 158 of the licensing act 2003, to make a false statement in or in connection with this application.

☐ Ticking this box indicates you have read and understood the above declaration

This section should be completed by the applicant, unless you answered "Yes" to the question "Are you an agent acting on behalf of the applicant?"

* Full name

* Capacity

Date (dd/mm/yyyy)

Continued from previous page...

Add another signatory

Once you're finished you need to do the following:

1. Save this form to your computer by clicking file/save as...
2. Go back to <https://www.gov.uk/apply-for-a-licence/premises-licence/epping-forest/apply-1> to upload this file and continue with your application.

Don't forget to make sure you have all your supporting documentation to hand.

IT IS AN OFFENCE, LIABLE ON SUMMARY CONVICTION TO A FINE NOT EXCEEDING LEVEL 5 ON THE STANDARD SCALE, UNDER SECTION 158 OF THE LICENSING ACT 2003, TO MAKE A FALSE STATEMENT IN OR IN CONNECTION WITH THIS APPLICATION

Epping Forest District Council

Consent of individual to being specified as premises supervisor

I Arafat Sayeed.....(insert name of prospective premises supervisor)

Of 50 SALLY ROAD
WIGBORNE, ESSEX
.....
(home address of prospective premises supervisor)

hereby confirm that I give my consent to be specified as the designated premises supervisor in relation to the application for variation of designated premises supervisor

by Castpan Ltd.....(name of applicant)

relating to premises licence N/A.....(number of existing licence if any)

for Cafe Bengel
41 THE BROADWAY, WIGBORNE, ESSEX
IG11 3SP
(name and address of premises to which application relates)

and any premises licence to be granted or varied in respect of this application made by the above applicant concerning the supply of alcohol at the above named premises.

I also confirm that I am applying for, intend to apply or currently hold a personal licence, details of which I set out below.

Personal Licence Number.. (insert personal licence number, if any)

Personal licence issuing authority ..
(insert name, address and telephone number of issuing authority, if any)

Signed...

Print Name Arafat Sayeed

Dated 18/08/2014

★★★★★
 * CAFE BENGAL *
 INDIAN RESTAURANT & TAKEAWAY
 FULLY LICENSED & AIR CONDITIONED
 AUTHENTIC INDIAN CUISINE

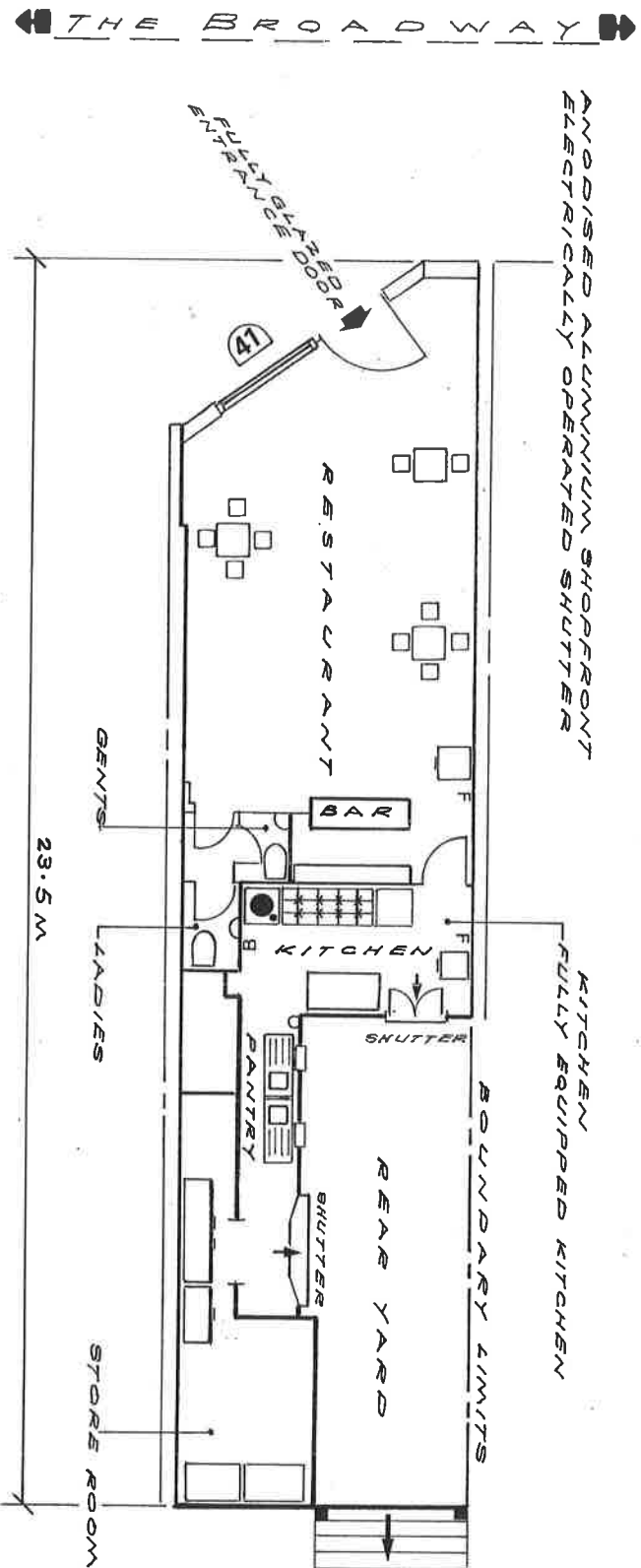

► LAYOUT OF RESTAURANT ◄

FOR LICENSING ACT 2003

KEY TO FIRE SYMBOLS
 F FIRE EXTINGUISHER
 B FIRE BLANKET IN CONTAINER

W.D ANTHONY & PARTNERS

Rivington Business Centre
 Rivington House
 82 Great Eastern Street
 London EC2A 3JL

Tel. 07721 096555



title **PROPOSED GROUND FLOOR PLAN**

scale 1:100 date 22 JUNE 2005

diag no. 52/2005

client CAFE BENGAL

no. date

revisions

notes

SITE ADDRESS

41 THE BROADWAY
 DEBODEN
 ESSEX IG10 3SD

Skip Hire

**A & A
 SKIP HIRE**
 All skips available
 Friendly, reliable service
 Tel:
020 8529 6902
07966 433791
 www.aatlondonskiphire.com

**TOWN
 SKIPS**
Excellent
 Prices & Service
 All Areas Covered
 Same Day
020 8887 6867
 townskips@aol.co.uk

**Hunt
 Skips**
 Fast Reliable
 Service
 Excellent Rates
020 8807 5948

**WOW
 FREE
 ADVERTISING!**
 Log on NOW!
 guardian-series.
 co.uk/ads247

Gardener's Plot

Fencing Services

**AK FENCING
 LANDSCAPING**

10 yrs. exp.
 All types of fencing
 supplied and fitted.
 Also garden turfing, Decking,
 Block paving and Patios.
**FREE ESTIMATES
 AND ADVICE**
0208418 9788
07973 439226
 www.akfencing-landscaping.co.uk
 akfencing@btinternet.com

Gardening Maintenance

**TURF
 SUPPLIES**

Relovelling and new lawns laid.
 Good quality
 All garden work undertaken
 Free estimates
01279 718555
07930 188920

ALL GARDENING (+ clear-
 ance/fencing) All main-
 tenance from mowing to
 pruning, Mr Elias (Land-
 scape Gardener) 07932
 984448

KJ GARDENING SERVICES

Fencing & Tree Work
 Ride on mower for larger gardens
 Fully licenced waste carrier
 Client References available
Contact Beau 07947 807900
After 6pm 020 8500 8470
 www.kjgardening.co.uk | Public Liability Insurance

TAYLOR TREE CARE

All Types of Trees Expertly
 • Felled • Planted • Shaping
 • Stumps Ground Out
 • Overgrown Gardens Cleared • Fencing
 Free Quotes
0208 485 9279
07769 313 080 www.tortreecarelondon.co.uk

Landscaping & Gardening

Garden Service Ltd
Marshall's register
Patios, Decking, Brick walls,
Fences, Driveways, Lawns
Garden Creators
Call 0203 174 1619
Or 0800 232 1877
Or Paul on 07980 390 824
www.gardencreators.co.uk

Tell us about
 your business

Do you have some
 news to share?
 It's never been easier.
 Just visit
 guardian-series.co.uk/
 trade_directory

Chatlines

Public Notices

GLADYS MAUD RIPLEY (Deceased)

Pursuant to the Trustee Act 1925
 any persons having a claim against
 or an interest in the Estate of the
 aforementioned deceased, late of
 Cunningham House Park Way
 North Weald Epping Essex CM16
 6SL, who died on 11/04/2014, are
 required to send particulars thereof
 in writing to the undersigned
 Solicitors on or before 14/11/2014,
 after which date the Estate will be
 distributed having regard only to
 claims and interests of which they
 have had notice.
SPIRE SOLICITORS LLP
 The Pines 50 Connaught Road
 Fitzrovia W1T 3EP
 (Ref: VHP/CML) T419314

Notice of Application for a new Premises Licence under the Licensing Act 2003

Notice is given this day 2nd September 2014 that Castan Ltd. Of
 45 Roman Road, East Ham, E6 3RX has applied to the Licensing
 office of Epping Forest District Council for a Premises Licence
 in respect of Cafe Bengal, 41 The Broadway, Loughton, Essex,
 IG10 3EP. The proposed licence is for alcohol and Recorded music
 licence being sold between 11:00 hrs to 00:00 hrs from Monday to
 Saturday, and Sunday between 11:00 hrs to 23:30 hrs and late
 night refreshments between 11:00 hrs to 00:00 hrs Monday to
 Saturday and 10:00 hrs to 23:30 hrs on Sunday. The register of
 licensed premises is maintained at the Licensing office of Epping
 Forest District Council, Civic Offices, High Street, Epping, Essex,
 CM16 4BZ. Applications for the premises licence may be inspected at
 this office during office hours. Anyone wishing to oppose this
 application must give written notice to the licensing officer within
 28 days of this notice. It is an offence knowingly or recklessly
 to make false statement in connection with an application which
 could lead to a fine on summary conviction (Maximum £5000)

PUBLIC NOTICE LOCAL GOVERNMENT (MISCELLANEOUS PROVISIONS) ACT 1982

Street Trading Consent
 Application has been made by
 John Henry White to Epping
 Forest District Council for
 consent to sell plants, flowers
 and trees at B1393, Epping Road
 Mon - Sun at 08:00 - 21:00 hrs.
 Any representations regarding
 this application should be made
 within 21 days of this notice to:
 Corporate Support Services,
 Epping Forest District Council,
 Civic Offices, 223 High Street,
 Epping, Essex CM16 4BZ
 T416379

FITZ ARPINE BRYAN (Deceased)

Pursuant to the Trustee Act 1925
 any persons having a claim
 against or an interest in the Estate
 of the aforementioned deceased,
 late of 43 Colchester Road
 London E17 8NU, who died on
 12/08/2014, are required to send
 particulars thereof in writing to the
 undersigned on or before
 14/11/2014, after which date the
 Estate will be distributed having
 regard only to claims and interests
 of which they have had notice.
**THE CO-OPERATIVE LEGAL
 SERVICES LIMITED**
 Aztec 650 Aztec West
 Almondsbury Bristol BS32 4SD
 (Ref: CSE93424010P/Bryar) T416379

Horoscopes with Claire Petulengro

WEEKLY HOROSCOPES BY
 CLAIRE PETULENGRO

WEEK COMMENCING SATURDAY 30TH AUGUST

ARIES (March 21st-April 20th)

Bad news you've already received makes way for good news
 as you're about to learn how good your sign is at getting
 out of a sticky situation. Time spent with family can help you
 learn what has really gone on in their lives in recent weeks.
 Supporting each other gives you back the faith that's been
 lacking. Ring now for a surprise announcement.

TAURUS (April 21st-May 21st)

You seem to be juggling funds this week and you may find
 it hard to know if you're in credit or debt. Everything has the
 ability to work out well for you if you'd face facts instead of
 imagining them. Travel plans prove to you that someone has
 given you their loyalty. Give me a ring to hear why this is a
 great week to start a new job.

GEMINI (May 22nd-June 21st)

Spend some time with your loved ones this week. A meeting
 of minds can ensure that you approach the future as a team,
 rather than working against each other. Utilising old skills
 midweek can put you in touch with faces that can make you
 your fortune. Give me a ring now to hear why you shouldn't
 rule out house moves.

CANCER (June 22nd-July 23rd)

Stop trying to manage everything on your own and accept
 the help which those around you are trying to offer.
 The moon makes you more emotional than usual this
 weekend and could see you agreeing to things you'll regret.
 Think and ask for time, if it's the first time you've heard what's
 available. Phone me so we can talk this week through more.

LEO (July 24th-August 23rd)

Why have you left a bad air to stew between you and a
 close one? Surely it would be far better to talk things out?
 You're worried because others are watching, but the sooner
 you clear the air, the sooner you'll see that you were both
 working towards the same goals, just with different styles.
 Ring now so I can help you see life clearly.

VIRGO (August 24th-September 23rd)

You are going to have to make your family a priority this
 week, or you could find a falling out that is not easily
 repaired. Long distance relationships however are well
 starred and could have the makings of something permanent
 in your future. Ring now to hear why it's imperative you turn
 up on time, or even early, for all meetings.

LIBRA (September 24th-October 23rd)

Try to stick to your word in business this week, as more
 people are watching you than you think. You may be of
 the mind that small changes are ok, but I beg to differ.
 They could be the reason you lose the support for a personal
 change you want in your work at the end of the week. Ring
 now to hear how love and white lies are in the office.

SCORPIO (October 24th-November 22nd)

You'll want to tell half truths in order to save other's feelings,
 when you should be telling them the facts. It's the only way they'll
 be able to deal with the issues properly. Smile at strangers this
 week. Impromptu meetings ensure your life starts to get more
 than a little interesting. Ring now to hear how exciting your work
 sector is getting this month.

SAGITTARIUS (November 23rd-December 21st)

New relationships come under a lot of pressure from the
 stars and you may be finding it hard to work out your
 feelings. You know sometimes you can be your own worst
 critic. Stop over-analysing and instead just feel your way
 through the events in the next seven days. Give me a ring
 now to hear about a new admirer you've earned.

CAPRICORN (December 22nd-January 20th)

Education is important this week Capricorn. Make sure that
 if there is the chance for you to expand your knowledge,
 you accept it. Not even you can know everything.
 Word from someone you have not heard from recently puts
 a skip in your step and helps you to feel optimistic about
 relationships. Ring me. We need to talk about last weekend.

AQUARIUS (January 21st-February 19th)

Although you're seeing a new side to a close one's character,
 don't immediately think that they don't fit into your life.
 The fact that they're opened up to you means that they
 trust you more, not less. Let time be the judge of how
 well you work as a team. Better still, let your heart decide.
 Call now to hear why I think you can aim higher in business.

PISCES (February 20th-March 20th)

This is a great time to sign up for a course or lecture,
 or anything which enables you to polish up old skills or learn
 new ones. A broken promise is meant to be and is replaced by
 something better. Friends turn into romantic interests for some
 of you Pisces. Ring now to hear why it's worth calling up family
 and making the effort to see them this week.

LIVE PSYCHIC
 Discover your destiny

0906 570 5965

Service Provider: Pronomedia. Astrology Calls 60p per
 minute. Psychic live service £1.50 per minute. Customer
 Service 0800 140 9049. ICSTIS Registered.

Let us help you put
 the pieces together



For all your
 leaflet needs call

Tel: 01494 755106
 Fax: 01494 755165
 letterbox@london.newsquest.co.uk

LETTERBOX
 letterboxlondon.co.uk

CLICK **find**

It's the business directory
 you want to be on.



**FREE
 Business
 listings from
 your local
 newspaper.**

Call: 0208 722 6414
 or join online at:
 guardian-series.co.uk/click2find

© 2013 Newsquest.



Licensing Department, Loughton Police Station
158 High Road, Loughton, IG10 4BE
Telephone: 01279 625 405

Website: www.essex.police.uk

Email: Peter.Jones@essex.police.uk

Neighbourhoods Director
Civic Offices High Street
Epping Essex CM16 4BZ

Telephone: 01992 564000
DX: 40409 Epping

Director of Neighbourhoods
and Deputy Chief Executive
Derek Macnab

Enquiries to:

Mrs Kim Tuckey
Licensing Department
Epping Forest District Council
Civic Offices
High Street
Epping
CM16 4BZ

18 September 2014

Dear Kim,

LICENSING ACT 2003 – GRANT OF PREMISES LICENCE SECTION 17

NEW PREMISE: Café Bengal, 41 The Broadway, Loughton

DPS: Arafat Sayeed

APPLICANT: Castpan Limited

Further to the above application for the Grant of a Premises Licence received on 15 August 2014. I can now confirm that all my checks have been carried out and can confirm that Essex Police will not be making any representations or objections to this application in respect of the licensing objectives.

I trust the aforementioned will assist and look forward to receiving a copy of the Licence, if/when processed, in due course.

Yours sincerely,

Mr Peter Jones ABII
Epping & Brentwood Licensing Officer
West LPA

**Cc. Castpan Limited
4A Roman Road
East Ham
London
E6 3RX**

Essex County Fire & Rescue Service

Mr David Johnson LL.B(Hons), BSc, MA, MSc, FCMl
Chief Fire Officer & Chief Executive



Sarah Kits
Licensing Compliance Officer
EFDC
Civic Offices
High Street
Epping
CM16 4BZ

WEST AREA COMMAND
Harlow Service Delivery Point
Fourth Avenue
HARLOW
CM20 1DU
☎ 01279 420841
✉ he.command@essex-fire.gov.uk

Date: 18 August 2014
Our Ref: 72/200001058169
Your Ref:
Enquiries to: Steve Nicholl

Dear Madam,

LICENSING ACT 2003
THE REGULATORY REFORM (FIRE SAFETY) ORDER 2005
Premises: Café Bengal 41 The Broadway Loughton IG10 3SP

Receipt is acknowledged of the above consultation, which will be audited by the Essex Fire Authority (The Authority).

Should there be any significant concerns regarding the application you will be notified in due course.

Yours faithfully

S. W. Nicholl
Technical Fire Safety Officer

Sarah Kits

From: Joanne Owen
Sent: 28 August 2014 09:21
To: Sarah Kits
Subject: FW: Licence Application

From: Sue Mills, Business Support Administrator [<mailto:Sue.Mills@essex.gov.uk>]
Sent: 27 August 2014 12:04
To: Joanne Owen
Cc: [REDACTED]
Subject: Licence Application

RE: Licensing Act 2003:- Café Bengal – IG10 3SP

The licensing application received on 15 August 2014 has been assessed and we can confirm we have no objections to this licence application but would encourage the applicant to advertise Challenge 25 and ensure all staff are trained to do so

Licensing Applications
Quality Assurance & Safeguarding (inc IRO) Service
Family Operations
E2, County Hall
Chelmsford CM1 1YS
Tel: 01245 436744 Email: LicenceApplications@essex.gov.uk

Kind Regards

Sue Mills
Business Support Administrator
Business Support
Corporate Services

Essex County Council
Telephone: 03330131499
Email: sue.mills@essex.gov.uk | www.essex.gov.uk
PLEASE NOTE OUR NEW TELEPHONE NUMBER! - Our old landline numbers will be disconnected shortly.
(Calls to this number will be charged at a local call rates.)

This email (including any attachments) is intended only for the recipient(s) named above. It may contain confidential or privileged information and should not be read, copied or otherwise used by any other person unless express permission is given. If you are not a named recipient, please contact the sender and delete the email from your system. It is the recipient's responsibility to ensure that appropriate measures are in place to check for software viruses.

Sarah Kits

From: Audrey Chapman, Business Support Assistant <Audrey.Chapman@essex.gov.uk>
Sent: 15 August 2014 16:25
To: Licensing
Subject: Cafe Bengal, 41 The Broadway, Loughton IG10 3SP

From Essex County Council Trading Standards

Dear Sir/Madam

Acknowledging receipt of a premises licence application for the above premises.

Audrey Chapman
Business Support Officer
Business Support
Corporate Services

Essex County Council
Telephone: 03330 131 253
Email: audrey.chapman@essex.gov.uk www.essex.gov.uk

This email (including any attachments) is intended only for the recipient(s) named above. It may contain confidential or privileged information and should not be read, copied or otherwise used by any other person unless express permission is given. If you are not a named recipient, please contact the sender and delete the email from your system. It is the recipient's responsibility to ensure that appropriate measures are in place to check for software viruses.

This email (including any attachments) is intended only for the recipient(s) named above. It may contain confidential or privileged information and should not be read, copied or otherwise used by any other person unless express permission is given. If you are not a named recipient, please contact the sender and delete the email from your system. It is the recipient's responsibility to ensure that appropriate measures are in place to check for software viruses.

Our Ref: L1.1/VRM

Ms Sarah Kits
Licensing Section
Epping Forest District Council
Civic Offices
Epping CM16 4BZ
(Emailed: skits@eppingforestdc.gcsx.gov.uk)

10 September 2014



LOUGHTON
TOWN COUNCIL

1 Buckingham Court, Rectory Lane
Loughton, Essex IG10 2QZ
Telephone: 020 8508 4200
Facsimile: 020 8508 4400
e-mail: contact@loughton-tc.gov.uk
Web site: www.loughton-tc.gov.uk

Town Clerk: Enid K Walsh

e-mail: contact@loughton-tc.gov.uk
 extn 207

Dear Ms Kits

Re: Notice of application for a new premises licence under the Licensing Act 2003 in respect of Café Bengal, 41 The Broadway, Loughton IG10 3RX

The Planning and Licensing Committee considered this application at its meeting on 8 September 2014.

The Committee asked if the closing times applied for could all be reduced by half an hour to allow patrons and staff clearing up to leave earlier, thereby reducing noise disturbance to residents in the flats above.

Yours sincerely

A faint, stylized signature of Vivienne Messenger, appearing as a series of connected loops and curves.

Vivienne Messenger
Planning Committee Clerk

Nuala Clark

From: David Linnell <david.linnell@loughtonresidents.co.uk>
Sent: 13 October 2014 15:57
To: Licensing
Subject: RE: Cafe Bengal

Hi

In view of the email below, we are happy to withdraw our objection to the licensing application.

Regards

David Linnell
Loughton Residents Association Plans Group

From: Saad Miah [mailto:saad.miah@castpan.co.uk]
Sent: 13 October 2014 15:51
To: david.linnell@loughtonresidents.co.uk
Subject: Cafe Bengal

Sarah kits
Licensing department
Epping forest council

I Mr Saad Miah on behalf of Castpan Ltd trading as Cafe Bengal restaurant 41 the broad way loughton IG10 3SP. I have heard about the music playing in my restaurant could make some noise and make disturbance so as a responsible person I can promise you that the music which will be played in side the restaurant will not be heard from outside this will be done through my staff, they will be trained too keep the volume on a low level so neighbours will not be interrupted.

I hope you and other residence of my restaurant can take my word into account seriously and consider my license application.

Your sincerely

Barrington Road,
Loughton,
Essex.

25th September, 2014.

Dear Sir/Madam,

Cafe Bengal licence application; Ref WK/201428210

Thank you for your letter of 4-9-14 regarding the above.

The Police already have evidence of public nuisance and sometimes crime and disorder in the area outside Cafe Bengal and up Bricklamps Path which serves as a thoroughfare from Debden Broadway to the mass of houses north, west and east of the Broadway. The Police have already had to ban gatherings of young people in this area.

The proposal to permit the sale of alcohol until midnight will exacerbate the above problem and encourage people to linger late at night when they might otherwise disperse and go home. The sale of alcohol at the nearby off-licence, McColls, which unlike the proposal for Cafe Bengal, does not entail consumption on the premises, ceases at 11.00 pm (10.30 pm on Sundays). There is no reason why Cafe Bengal's requested licence should not similarly prevent the sale of alcohol after 11.00 pm (10.30 on Sundays).

The sale of recorded music could become a public nuisance if it is too loud, especially late at night directly under a block of residential dwellings, and the Sub-Committee may wish to consider a noise level limit, measurable in decibels immediately outside Cafe Bengal's premises.

Yours faithfully,

David Paget

Licensing Manager, Neighbourhoods Directorate,
Civic Offices, Epping CM16 4BZ.

